



45TH EPA CONGRESS

EUROPROSTHO

European Prosthodontics looks forward

September 22nd - 24th, 2022
University of Siena, Italy

PROGRAM



EPA European Prosthodontic Association



SIPRO
Società Italiana di
Protesi Dentaria e
Riabilitazione Orale

45TH EPA CONGRESS

EUROPROSTHO
European Prosthodontics looks forward

September 22nd - 24th, 2022
University of Siena, Italy

www.epa2022-siena.it

The 2022 annual Conference of the European Prosthodontic Association will be held in Siena, Italy, under the presidency of Professor Marco Ferrari.

Each year, in September, the Association holds an annual conference where members and others with interest in Prosthodontics can meet and make scientific and clinical presentations to foster interest in the study and development of Prosthodontics.

Scientific Committee

Marco Ferrari - *President - University of Siena*
Phophi Kamposiora - *University of Athens*
George Papavasileiou - *University of Athens*
Simone Grandini - *University of Siena*
Costanza Micarelli - *SIPRO*
Fabio Carboncini - *University of Siena*

For young activities:

Giacomo Corsentino - *University of Siena*
Edoardo Ferrari Cagidiaco - *University of Siena*
Giulia Gallo - *University of Siena*

MAIN TOPICS

Dental Implants

Fixed Prosthodontics

Occlusion

Perio-Prosthodontic relations

Digital Dentistry

Ortho-Prosthodontic relations

Geriatrics

Esthetics & Prosthodontic Materials

Complex Treatment Planning

Adhesive Prosthodontics

Prosthodontic Contest 2022

Faculty

Some **International Speakers** who already confirmed their participation

www.epa2022-siena.it

Agnini Alessandro - *SIPRO, Italy*
Agnini Mastrorosa Andrea - *SIPRO, Italy*
Att Wael - *Tufts University, Massachusetts*
Biscaro Leonello - *SIPRO, Italy*
Borracchini Andrea - *Siena University, Italy*
Breschi Lorenzo - *Bologna University, Italy*
Carboncini Fabio - *SIPRO, Italy*
Casucci Alessio - *Montepulciano, Italy*
Cattoni Francesca - *San Raffaele Vita - Salute, Italy*
Colonna Anna - *Udine, Italy*
De Sanctis Massimo - *San Raffaele Vita - Salute, Italy*
Doldo Tiziana - *Siena University, Italy*
Ercoli Carlo - *Rochester University, New York*
Ferrari Marco - *Siena University, Italy*
Fonzar Alberto - *Udine, Italy*
Goracci Cecilia - *Siena University, Italy*
Grandini Simone - *Siena University, Italy*
Habsha Effie - *Toronto University, Canada*
Imburgia Mario - *SIPRO, Italy*
Joda Tim - *Zurich University, Switzerland*
Kamposiora Phophi - *Athens University, Greece*
Keeling Andrew - *Leeds University, UK*
Koken Serhat - *Siena University, Italy*
Lobbezoo Frank - *ACTA University, Netherlands*
Loi Ignazio - *SIPRO, Italy*
Malament Kenneth - *Tufts University, Massachusetts*
Manacorda Michele - *San Raffaele Vita - Salute, Italy*
Manfredini Daniele - *Siena University, Italy*
Martignoni Marco - *Siena University, Italy*
Merli Mauro - *SIPRO, Italy*
Micarelli Costanza - *SIPRO, Italy*
Müller Frauke - *Geneve University, Switzerland*
Poggio Paola - *SIPRO, Italy*
Poggio Carlo - *SIPRO, Italy*
Pozzi Alessandro - *Rome, Italy*
Rutkunas Vygasdas - *Vilnius University, Lithuania*
Sorrentino Roberto - *University Federico II Naples, Italy*
Venezia Piero - *Bari, Italy*
Vichi Alessandro - *Siena University, Italy*
Vinci Raffaele - *San Raffaele Vita - Salute, Italy*
Zarone Fernando - *University Federico II Naples, Italy*

45th EPA Congress, Siena 2022					
Thursday 22 September					
	Room A		Room B		Room C
09:00 - 10:30	Oral presentation	09:30 - 10:30	Workshop sponsor: 3M Success Simplified: Connecting professionals to optimize indirect restoration workflows <i>Stefan Vandeweghe</i>	09:00 - 10:30	Oral presentation
10:30 - 11:00 Break and Poster view					
11:00 - 13:00	Oral presentation	11:00 - 12:00	Workshop sponsor: Sweden & Martina The use of PRAMA implant in patient rehabilitation: from localized edentulism to the treatment of terminal dentition <i>Luca De Stavola, Leonello Biscaro</i>	11:00 - 13:00	Oral presentation
		12:00 - 13:00	Prosthetic Rehabilitation of atrophic jaws: The Digital Work-Flow <i>Michele Manacorda, Raffaele Vinci, Francesca Cattoni</i>		
13:00 - 14:00 Lunch and Poster view					
14:00 - 16:30	Criteria of choice for the maintenance of the severely compromised tooth <i>Simone Grandini, Marco Martignoni, Fabio Carboncini</i>	14:00 - 15:00	Workshop sponsor: Kuraray Noritake Feather Edge Preparations for Zirconia Restorations in Full Digital Workflow <i>Carlo Poggio</i>	14:00 - 16:00	Oral presentation
		15:00 - 16:00	Workshop sponsor: GC GC's workflow: success simplified from scanning to luting <i>Moderator: Marco Ferrari</i> <i>Speaker: Matteo Basso, Juraj Brozovic</i>		
16:30 - 18:20	Oral presentation	16:00 - 18:00	Oral presentation		
18:00 - 20:00 Welcome Reception					

45th EPA Congress, Siena 2022			
Friday 23 September			
08:30 - 09:00	Welcome		
09:00 - 10:00	Lectio Magistralis // Carlo Ercoli		
10:00 - 10:30	Break and Poster view		
	Room A		Room B
10:30 - 11:10	Tissues speak...and the dentist must listen <i>Fabio Carboncini</i>	10:30 - 11:50	Integrated Digital Workflow in Implant Therapy <i>Mauro Merli, Mario Imburgia</i>
11:10 - 11:50	The prosthetic rehabilitation of patients affected by sever periodontal disease: a critical analysis <i>Alberto Fonzar</i>		
11:50 - 12:20	Evolution from Analogue to Digital Workflow in Prosthodontic rehabilitation on natural dentition <i>Alessandro Agnini, Andrea Mastrosera Agnini</i>	11:50 - 12:10	Digital workflow for full-arch implant dentistry 2.0 <i>Wael Att</i>
12:20 - 12:50	Digital impressions and occlusal relation recording in complex treatments: time to rethink old concepts? <i>Carlo Poggio</i>	12:10 - 12:50	Practice oriented digital implant prosthodontics for the extensive cases <i>Vygandas Rutkunas</i>
12:50 - 14:00	Lunch and Poster view		
14:00 - 14:25	Science for adhesive cementation <i>Lorenzo Breschi</i>	14:00 - 14:40	Management of peri-implant soft tissue: between biology and esthetic <i>Massimo De Sanctis</i>
14:25 - 14:55	Adhesive cementation in Prosthodontics: state of the art and clinical protocols <i>Roberto Sorrentino</i>		
14:55-15:20	Cervical Margin Elevation: a scientific and clinical approach <i>Serhat Koken</i>		
15:20 - 16:20	Management of soft tissue <i>Ignazio Loi</i>	15:20 - 16:20	Paving the Digital Pathway in Implant Dentistry <i>Effie Habsha, Costanza Micarelli, Phophi Kamposiora</i>
16:20 - 17:00	Discussion & Round table	16:20 - 17:00	Discussion & Round table

45th EPA Congress, Siena 2022			
Saturday 24th September			
	Room A		Room B
09:00 - 09:40	Recent (r)evolutions in treating edentulous patients – implant overdentures and digital workflows <i>Frauke Müller</i>	09:00 - 09:40	Zirconia vs Disilicate... what a challenge! <i>Fernando Zarone</i>
09:40 - 10:20	The meaning of removable prosthodontics and natural dentition today and tomorrow <i>Andrea Borracchini</i>	09:40 - 10:20	An advanced perspective on lithium disilicate restorations in the age of zirconia <i>Kenneth Malament</i>
10:20 - 10:45	Discussion	10:20 - 10:45	Discussion
10:45 - 11:15	Break and Poster view		
11:15 - 12:30	Orthodontics in prosthetic cases: is the usual orthodontics? <i>Paola Poggio, Leonello Biscaro</i>	11:15 - 11:55	Bruxism assessment <i>Frank Lobbezoo</i>
		11:55 - 12:35	Bruxism and pain <i>Daniele Manfredini</i>
		12:35 - 13:15	Bruxism and sleep apnea <i>Anna Colonna</i>
12:30 - 13:00	Complete Digital Implant Workflow: Fake or Reality? <i>Tim Joda</i>	13:15 - 13:30	Discussion
13:00 - 13:30	Occlusion and Digital Dentistry - Future Solutions to Raise the Standard of Care <i>Andrew Keeling</i>		
13:30 - 14:30	Best Oral & Poster Presentation Awards - Closing		
After the congress			
14:30 - 15:40	Annual Business Meeting (ABM)		

PROGRAM

45TH EPA CONGRESS

EUROPROSTHO

European Prosthodontics looks forward

Thursday September 22, 2022

ROOM A

09:00 - 10:30 Oral presentation

10:30 - 11:00 Break and Poster view

11:00 - 13:00 Oral presentation

13:00 - 14:00 Lunch and Poster view

14:00 - 16:30 Criteria of choice for the maintenance
of the severely compromised tooth
Fabio Carboncini, Simone Grandini, Marco Martignoni

16:30 - 18:20 Oral presentation

ROOM B

09:30 - 10:30 Workshop sponsor 3M
Success Simplified: Connecting professionals
to optimize indirect restoration workflows
Stefan Vandeweghe

10:30 - 11:00 Break and Poster view

11:00 - 12:00 Workshop sponsor Sweden & Martina
The use of PRAMA implant in patient rehabilitation:
from localized edentulism to the treatment
of terminal dentition
Leonello Biscaro, Luca De Stavola

12:00 - 13:00 Prosthetic Rehabilitation of atrophic jaws: The Digital Work-Flow
Francesca Cattoni, Michele Manacorda, Raffaele Vinci

13:00 - 14:00 Lunch and Poster view

14:00 - 15:00 Workshop sponsor Kuraray Noritake
Feather Edge Preparations for Zirconia Restorations
in Full Digital Workflow
Carlo Poggio

Thursday September 22, 2022

ROOM B

15:00 - 16:00 Workshop sponsor GC
GC's workflow: success simplified from scanning to luting
Moderator: *Marco Ferrari*
Speakers: *Matteo Basso, Juraj Brozovic*

16:00 - 18:00 Oral presentation

ROOM C

09:00 - 10:30 Oral presentation

10:30 - 11:00 Break and Poster view

11:00 - 13:00 Oral presentation

13:00 - 14:00 Lunch and Poster view

14:00 - 16:00 Oral presentation

18:00 - 20:00 Welcome Reception

Friday September 23, 2022

Program

ROOM A

08:30 - 09:00 Welcome

09:00 - 10:00 Lectio Magistralis

Carlo Ercoli

10:00 - 10:30 Break and Poster view

Chairs: *Andrea Borracchini, Daniele Manfredini*

10:30 - 11:10 Tissues speak...and the dentist must listen

Fabio Carboncini

11:10 - 11:50 The prosthetic rehabilitation of patients affected
by sever periodontal disease: a critical analysis

Alberto Fonzar

11:50 - 12:20 Evolution from Analogue to Digital Workflow
in Prosthodontic rehabilitation on natural dentition

Alessandro Agnini, Andrea Mastrosera Agnini

12:20 - 12:50 Digital impressions and occlusal relation recording
in complex treatments: time to rethink old concepts?

Carlo Poggio

12:50 - 14:00 Lunch and Poster view

Chairs: *Alessandro Agnini, Fernando Zarone*

14:00 - 14:25 Science for adhesive cementation

Lorenzo Breschi

14:25 - 14:55 Adhesive cementation in Prosthodontics:
state of the art and clinical protocols

Roberto Sorrentino

Friday September 23, 2022

ROOM A

14:55 - 15:20 Cervical Margin Elevation: a scientific and clinical approach
Serhat Koken

15:20 - 16:20 Management of soft tissue
Ignazio Loi

16:20 - 17:00 Discussion & Round table

ROOM B

Chairs: *Leonello Biscaro, Piero Venezia*

10:30 - 11:50 Integrated Digital Workflow in Implant Therapy
Mario Imburgia, Mauro Merli

11:50 - 12:10 Digital workflow for full-arch implant dentistry 2.0
Wael Att

12:10 - 12:50 Practice oriented digital implant prosthodontic
for the extensive cases
Vygandas Rutkunas

12:50 - 14:00 Lunch and Poster view

Chairs: *Cecilia Goracci, Carlo Poggio*

14:00 - 14:40 Management of peri-implant soft tissue: between biology and esthetic
Massimo De Sanctis

14:40 - 15:20 Navigation guided surgery & prosthetics for terminal dentition and
complete edentulous patients
Alessandro Pozzi

15:20 - 16:20 Paving the Digital Pathway in Implant Dentistry
Effie Habsha, Phophi Kamposiora, Costanza Micarelli

16:20 - 17:00 Discussion & Round table

Saturday September 24, 2022

ROOM A

Chairs: *Alessio Casucci, Tiziana Doldo, Alessandro Vichi*

09:00 - 09:40 Recent (r)evolutions in treating edentulous patients
implant overdentures and digital workflows
Frauke Müller

09:40 - 10:20 The meaning of removable prosthodontics and natural
dentition today and tomorrow
Andrea Borracchini

10:20 - 10:45 Discussion

10:45 - 11:15 Break and Poster view

11:15 - 12:30 Orthodontics in prosthetic cases: is the usual orthodontics?
Leonello Biscaro, Paola Poggio

12:30 - 13:00 Complete Digital Implant Workflow:
Fake or Reality?
Tim Joda

13:00 - 13:30 Occlusion and Digital Dentistry
Future Solutions to Raise the Standard of Care
Andrew Keeling

13:30 - 14:30 Best Oral & Poster Presentation Awards - Closing

ROOM B

Chairs: *Fabio Carboncini, Simone Grandini, Roberto Sorrentino*

09:00 - 09:40 Zirconia vs Disilicate... what a challenge!
Fernando Zarone

09:40 - 10:20 An advanced perspective on lithium disilicate restorations
in the age of zirconia
Kenneth Malament

10:20 - 10:45 Discussion

Saturday September 24, 2022

ROOM B

10:45 - 11:15 Break and Poster view

11:15 - 11:55 Bruxism assessment

Frank Lobbezoo

11:55 - 12:35 Bruxism and pain

Daniele Manfredini

12:35 - 13:15 Bruxism and sleep apnea

Anna Colonna

13:15 - 13:30 Discussion

After the Congress

14:30 - 15:40 Annual Business Meeting (ABM)

ORAL PRESENTATIONS

45TH EPA CONGRESS

EUROPROSTHO

European Prosthodontics looks forward

Thursday, September 22, Room A

09:00 - 10:30 Oral presentation - Clinical Research

09:00 - 09:10 • CO01 Extra Oral Maxillofacial Prosthetics: Regaining Confidence and Improving Patient's Quality of Life

Muhammad Amal Abd Wahab, Tengku Fazrina Tengku Arif

09:10 - 09:20 • CO02 New Lip Filler Technique using a MicroCannula Technique (The 3 point Lips)

Noury Adel

09:20 - 09:30 • CO03 Neurotoxins & Fillers: DentoFacial Aesthetics

Noury Adel

09:30 - 09:40 • CO04 Perspectives of Satisfaction in Patients with an Implant-Crown in the Aesthetic Zone

Kelvin I. Afrashtehfar, S. Ross Bryant

09:40 - 09:50 • CO05 Interdisciplinary interface between prosthodontics and periodontics: case presentation

Hayat Taresh Alalili

09:50 - 10:00 • CO06 Orthodontic-Prosthodontic Treatment of Third Class Case with Variation of Vertical Dimension of Occlusion

Basetti Nazzareno

10:00 - 10:10 • CO07 Prosthetically Guided Maxillofacial and Oral Surgery: the Updated Protocol for the Rehabilitation of Cancer Patients.

Leonardo Ciocca, Achille Tarsitano, Riccardo Mattoli, Cristiana Breccia, Pietro Felice, Lorenzo Breschi

10:10 - 10:20 • CO08 Impact of the COVID-19 pandemic on symptoms of temporomandibular joint disorders (TMD)

Azize Demir, Demet Çağıl Ayvalıoğlu

10:20 - 10:30 • CO09 Efficacy of Botulinum Toxin and LLLT to Treat Myofascial Pain and Regional Oxygen Levels on Masseter Muscles

Ugur Hilaloglu, Nermin Demirkol, Mehmet Demirkol

Thursday, September 22, Room A

11:00 - 13:00 Oral presentation - Clinical Research

11:00 - 11:10 • CO10 Retrospective clinical study of 1472 monolithic zirconia restorations with feather-edge margins realized by using a digital workflow.

Adolfo Di Fiore, Edoardo Stellini

11:10 - 11:20 • CO11 Fracture Resistance of Individually Formed and Prefabricated Fiber Post in Reinforced Structurally Compromised Teeth

Dina El-Shokafy, Mohamed Ayad, Mohamed Seddik, Waleed Elshahawy

11:20 - 11:30 • CO12 Retrospective clinical study of tooth-supported single crowns: A multifactor analysis.

Mohammed Hawthana, Bruno R. Chrcanovic, Christel Larsson

11:30 - 11:40 • CO13 The effect of full-face and close-up photos of patients on the perception of smile esthetics

Burcu Kanpalta

11:40 - 11:50 • CO14 Efficiency of Hepa-filtered suction unit on aerosols during anterior tooth preparation

Irem Karagözoglu, Nermin Demirkol, İpek Koçer

11:50 - 12:00 • CO15 Esthetic rehabilitation with CAD/CAM resin bonded bridge for single edentulous space and ankylosed tooth

Ju-Sun Lee, Joo-Hee Shin

12:00 - 12:10 • CO16 Sports Dentistry: Beyond a Mouthguard!

Abdulmajeed Okshah

12:10 - 12:20 • CO17 Covid-19 and its consequences into the Oral Cavity

Alketa Qafmolla

12:20 - 12:30 • CO18 Impact of Preservation of Tooth on the Outcome of Restoring Endodontically Treated Teeth

Noushad Rahim, Rupert Austin, Shanon Patel, Federico Foschi, Francesco Mannocci

12:30 - 12:40 • CO19 Electromyographic assessment of masseter muscle activity: a proposal for a 24hr recording device with preliminary data

Nicolò Giuseppe Sorrenti, Anna Colonna, Lorenzo Noveri, Alessandro Bracci, Daniele Manfredini

12:40 - 12:50 • CO20 Smile and Profile Aesthetic Parameters of East Asians: A Systematic Review

Chon Pei (Denny) Wang, Wing Ho (Manuel) Man, Raelene Sambrook

12:50 - 13:00 • CO21 Enamel wear caused by monolithic zirconia crowns following one year of clinical use

Genç Zenunaj, Alketa Qafmolla, Ruzhdie Qafmolla

Thursday, September 22, Room A**16:30 - 18:20 Oral presentation - Prosthodontic research**

16:30 - 16:40 • CO55 Dental Abutment Clinical Management Affects Clot Formation on Abutment Surface: In Vitro Study

Habibe Öztürk Ulusoy, Esra Ercan, Orhan Özatik, Mustafa Tunali

16:40 - 16:50 • CO56 Color, Gloss and Surface Roughness Changes of CAD-CAM Composite Materials After Three Aging Procedures.

Ioannis Papathanasiou, Spiros Zinelis, George Papavasiliou, Phophi Kamposiora

16:50 - 17:00 • CO57 Three-dimensional Radiographic and Histologic Assessment of Bone Ingrowth into Porous Nickel Titanium Dental Implant

Siti Nadia Rahimi, Noor Shafini Mohamad, Rohana Ahmad

17:00 - 17:10 • CO58 Comparison of Shade-Matching Accuracy with Various Digital Photographic Techniques: An In Vivo Study

Meltem Mert Eren, Ebubekir Saçlı, Demet Çağıl Ayvalhoğlu, Samim Çetin Sevük

17:10 - 17:20 • CO59 In-Vitro Comparison of the Microbial Leakage in Two Different Implant-Abutment Systems.

Basmah A.M. Sheikh, Yasemin Özkan, Yılmaz Umut Aslan, Yaşar Nakipoğlu

17:20 - 17:30 • CO60 Evaluation of the Efficacy of Photodynamic Therapy for Disinfection of Denture Base Material

Asli Sinci, Işıl Turp

17:30 - 17:40 • CO61 Effect of Bioactive Glass Particles on Mechanical and Adhesion Properties of Cements

Ece Ucar, Pekka Kalevi Vallittu, Lippo Veli Juhana Lassila, Isil Cekic Nagas

17:40 - 17:50 • CO62 The Effect of Beverages That Mostly Used in Covid-19 Pandemic on Universal Composite Staining

Ceren Elif Yavuz, Meltem Mert Eren, Günçe Ozan

17:50 - 18:00 • CO63 Influence of Material Composition and Thickness on Color Coordinates and Translucency of Glass-Ceramics Laminate Veneers

Tuba Yılmaz Savaş, Seda Yıldızlar

18:00 - 18:10 • CO64 Effect of Home Bleaching and Thermal Cycling on the Contrast Ratio of Resin Matrix Ceramics

Deniz Yılmaz, Sema Murat, Burcu Batak

18:10 - 18:20 • CO65 Optimization of the Laboratory Testing of Denture Adhesives Using a Novel Artificial Edentulous Mouth

Sana Zahabiyou, Mangala Patel, Trevor Coward, Lucy Di-Silvio

Thursday, September 22, Room B**16:00 - 18:00 Oral Presentation - Case Presentation**

16:00 - 16:10 • CO66 Prosthetic Treatment of a Patient with Non-Syndromic Oligodontia after Failure of Orthognatic Surgery

Federico Amoroso, Davide Cavagnetto, Eleonora Caratori Tontini, Edoardo Moccia, Federico Mussano

16:10 - 16:20 • CO67 Prosthetic Rehabilitation of Patients with Amelogenesis Imperfecta and Papillon-Lefèvre Syndrome: A Case Series

Cigdem Cebi Tuysuz, Cisel Kisa, Necla Demir, Emine Elif Mutafçilar Velioglu, Sema Hakki, Sefa Aydindogan

16:20 - 16:30 • CO68 Managing a difficult oral rehabilitation through digital protocol

Florin Eugen Costantinescu, Marian Vladimir Costantinescu

16:30 - 16:40 • CO69 VDO Registration Control with a 3D-Printed Bite in a Full-mouth Digital Adhesive Rehabilitation Case

Federico Del Bianco, Claudia Mazzitelli, Matteo Mazza, Tatjana Maravic, Annalisa Mazzoni, Lorenzo Breschi

16:40 - 16:50 • CO70 complex approaches in “full-mouth” implant-prosthetic rehabilitation

Forna Norina Consuela, Claudiu Topoliceanu, Agop-Forna Doriana

16:50 - 17:00 • CO71 Management of over erupt tooth using TADs for insufficient restorative space

Nadhirah Ghazali, Eleena Mohd Yusof, Al Imran Shahrul, Nik Mukhriz Nik Mustapha

17:00 - 17:10 • CO72 Retained deciduous teeth in the adult patient - save or extract?

Ilan Gilboa, Or Kfir

17:10 - 17:20 • CO73 Multidisciplinary aesthetic restoration of anterior teeth: A Case Report

Jiu Lin, Xinyi Fang, Jiefei Shen

17:20 - 17:30 • CO74 A Combination of Direct Composite Restoration using Injection Moulding Technique and Indirect Full Coverage Restoration in Managing Amelogenesis Imperfecta

Mohd Khairul Firdaus Mazlan, Melati Mahmud

17:30 - 17:40 • CO75 Implants or conventional prosthodontics to manage extremely abraded dentition in combination with partial edentulism? A debate based on two case reports.

Tzanakakis Em, Kamposiora P, Papavasileiou

17:40 - 17:50 • CO76 Alternative Impression Technique of Anterior Implant-Supported Restorations with Soft Tissue Contouring: A case Report

Bezya Yılık, Burcu Ermeç Dündar, Fehmi Gönültaş.

17:50 - 18:00 • CO77 A Digitally driven Full Mouth Rehabilitation for a Patient with Generalized Tooth Wear and Loss of Vertical Dimension . Multi-Disciplinary Approach

Rami Meshreki

Thursday, September 22, Room C

09:00 - 10:30 Oral presentation - Digital prosthodontic research

09:00 - 09:10 • CO22 The Effect of Different Post-Process Applications on The Color Stability of 3D-Printed Dental Materials

Dilara Seyma Alpkilic, Deger Ongul, Sabire Isler Deger

09:10 - 09:20 • CO23 Impact Of Ambient Light On The Accuracy Of An Intraoral Scanner; An In Vitro Study

Demet Çağıl Ayvalıoğlu, Meltem Mert Eren, Samim Çetin Seviük

09:20 - 09:30 • CO24 accuracy of milled frameworks fabricated with digital and plaster impressions: a clinical study

Francesco Bagansco, Nicolò Pancini, Francesco Pera , Paolo Pesce, Paolo Pera, Maria Menini

09:30 - 09:40 • CO25 Full Digital Workflow for Complete Rehabilitation of a Severe Wear Dentition Case

Smaranda Buduru, Manuela Taut, Oana Almasan, Andreea Kui

09:40 - 09:50 • CO26 From immediate to definitive complete dentures: a case report treated with fully digital workflow.

D'arrienzo LF, Casucci A, Ferrari M.

09:50 - 10:00 • CO27 Accuracy of Interim Printed Fixed Partial Dentures on Printed Casts

Luciana Maria Goguță, Florin Topală, Andrei Faur, Anca Jivănescu

10:00 10:10 • CO28 Accuracy of 3D printed models and implant-analog positions according to the implant-analog-holder offset, inner structure, and printing layer thickness: an in vitro study

Gan Jin, Seung-Ho Shin, June-Sung Shim, Keun-Woo Lee, Jong-Eun Kim

10:10 - 10:20 • CO29 Digital Complete Dentures Fabrication Using an Individualized Teeth Library Created from Patient's Twin Sister

Ioannis Kanellos, Panagiotis Lampropoulos, Antonia Lianou, Nikitas Sykaras, Ioannis Tampakos

10:20 - 10:30 • CO30 Digital Applications in Aesthetic Implant Rehabilitation of The Anterior Region After Trauma: A Case Report

Iu Lin, Xinyi Fang, Jiefei Shen

Thursday, September 22, Room C**11:00 - 13:00 Oral presentation - Digital prosthodontic research & Prosthodontic research**

11:00 - 11:10 • CO31 Accuracy And Reliability Five Different Dental Color Scales; an in vitro study
Demet Çağıl Ayvalıoğlu, Görkem Mümtaz, Meltem Mert Eren

11:10 - 11:20 • CO32 Comparison of Different Digital Programs Used in Occlusal Splint Design: An In-Vitro Study
Serra Okutan, Demet Ayvalıoğlu, Bilge Gokcen-Rohlig

11:20 - 11:30 • CO33 Efficient Fixed-Removable Full Mouth Reconstructions Utilising Novel Techniques in Conventional and Digital Workflows
Salman Pirmohamed

11:30 - 11:40 • CO34 Intraoral Scanners on Horizontal and Vertical Deep Subgingival Margins: Three-dimensional Analysis and Accuracy
Gennaro Ruggiero, Roberto Sorrentino, Renato Leone, Fernando Zarone

11:40 - 11:50 • CO35 A Systematic Review of the Literature on Different Scanning Protocols that Render a 3D Virtual Patient
Rashad Tashkandi, Charalampos Petridis

11:50 - 12:00 • CO36 Fabrication and Characterisation of Polymethyl Methacrylate Denture Base Enhanced with Linseed Oil (PMMA-L)
Nadiyah Abdullah Zawawi, Raja Azman Raja Awang, Nik Noor Idayu Nik Ibrahim, Hazlina Abdul Ghani

12:00 - 12:10 • CO37 Effect of Collagen Powder Supplements on Color Stability of Different CAD/CAM Materials
Rana Turunç Oğuzman, Buşra Abusalih

12:10 - 12:20 • CO38 The bone support rehabilitation in the pre-prosthetic surgical stage
Agop-Forna Doriana, Carmen Gabriela Stelea, Norina Consuela Forna

12:20 - 12:30 • CO39 Investigation of different surface conditioning methods and porcelain-composite bond strength in immediate dentin sealing procedure
Leyla Aksel, İrem Karagözoğlu

12:30 - 12:40 • CO40 Investigation of Cytotoxic Effects of Implant Abutments Manufactured from Different Materials on Fibroblast Cells
Aygun Cimentepe Elif, Yildirim Zafer, Bozok-Cetintas Vildan, Dunder Comlekoglu Mine, Karabece Cal Ebru

12:40 - 12:50 • CO41 Marginal Adaptation of CAD-CAM Partial Indirect Restorations:
A Systematic Review of In-vitro Studies

Mobina Bagherianlemraski

12:50 - 13:00 • CO42 Which Fabrication Technique Produces the Best Marginal Fit and Flexural
Strength for Provisional Restorations?

Shreena Bhatt, Lambis Petridis, Raelene Sambrook

Thursday, September 22, Room C

14:00 - 16:00 Oral presentation - Prosthodontic research

14:00 - 14:10 • CO43 Depth of Cure of Three Different Composite-Resin Restorative Materials
by Means of Surface Hardness Measurements

Sadullah Uctasli, Seyma Sirin, Irem Buyukates, Meryem Dormen

14:10 - 14:20 • CO44 Influence of Bleaching Agents on the Color Change
of Indirect Restorative Materials

Defne Canpolat, Ayşe Atay

14:20 - 14:30 • CO45 The effect of simulated gastric juice on the color stability of different
permanent prosthetic resin materials

Seda Cengiz, Neslin Velioglu, Aysegül Koroğlu, Dalindushe Abdulai, Beşar İzzetağa

14:30 - 14:40 • CO46 Profilometric Analysis of Surface Roughness of Enamel and Contemporary
Restorative Materials Subjected to Chewing Simulation.

Syed Rashid Habib

14:40 - 14:50 • CO47 The effect of different mouthwash that recommended for Covid-19
infection on the color change

Esra Nur İpek, Şule Tuğba Deniz, Burcu Diker

14:50 - 15:00 • CO48 Stress Distribution in One-Piece Zirconia Implants:
A Finite Element Analysis

Seyma Kilicarslan, Muhammet C. Bursa, Dilek P. Senyilmaz

15:00 - 15:10 • CO49 Physicochemical Behaviour of Preshaded and Internally Shaded
Monolithic Zirconia Materials

Beril Koyuncu, Gökhan Aksoy

15:10 - 15:20 • CO50 In-vitro Mechanical Strength of Monolithic Zirconia of Varying Yttria
Concentration: a Systematic Review

Manuel Wing Ho Man, Denny Chon Pei Wang, Raelene Sambrook

15:20 - 15:30 • CO51 Effects of Tooth Preparation Designs on Tissue Removal and Marginal/Internal Discrepancies in Partial Restorations

Edoardo Mancuso, Claudia Mazzitelli, Tatjana Maravic, Annamaria Forte, Lorenzo Breschi, Annalisa Mazzoni

15:30 - 15:40 • CO52 Risk factors and protective indicators of peri-implant diseases among psoriatic subjects. A cross-sectional study.

Crystal Marruganti, Carlo Gaeta, Edoardo Ferrari Cagidiaco, Marco Ferrari, Simone Grandini

15:40 - 15:50 • CO53 Exploiting the Universal Resin Cement Possibilities: the Hybrid Bonding Luting Technique (HyBoL)

Claudia Mazzitelli, Tatjana Maravic, Uros Josic, Edoardo Mancuso, Annalisa Mazzoni, Lorenzo Breschi

15:50 - 16:00 • CO54 Effect of scanbody material and mucosa modification technique on the accuracy of digital impressions of edentulous arches with multiple implants.

Goksoy Gorkem, Ayvalioglu Demet Çağıl, Almina Muric, Gokcen-Rohlig Bilge

POSTER SESSION

45TH EPA CONGRESS

EUROPROSTHO

European Prosthodontics looks forward

Thursday, September 22 - Clinical research

PP01 • Endodontic Irrigants and Their Activation Efficacy on Cleansing Post Space Root Canal Walls.

Ebrahim Alhassan, Manuela Marchese, Pontoriero IK Denise, Edoardo Ferrari Cagidiaco, Simone Grandini, Marco Ferrari

PP02 • Post-Retained Single Crowns versus Fixed Dental Prostheses:

A 10-Year Prospective Clinical Study

Laura Ambu, Giacomo Corsentino, Edoardo Ferrari Cagidiaco, Marco Ferrari

PP03 • Peri-implant tissue health in implant-supported fixed partial rehabilitations

Camilla Canepa, Rezzano Giada, Francesco Bagnasco, Francesca Delucchi, Paolo Pesce, Maria Menini

PP04 • Quality of Life from Complete Denture to Implant Supported

Fixed Denture 26 Years in Function

Jindrich Charvat, Hana Hubalkova, Magdalena Cesnekova, Marie Bartonova, Lenka Vavrickova

PP05 • Assessment Occlusal Morphology Zirconia Crowns:

Correlation Technique Versus Library Method

Adolfo Di Fiore, Riccardo Favero, Stefano Granata, Mengtianci Oscar Cheng, Edoardo Stellini

PP06 • “Laser Soft Tissue Design In Aesthetic Prosthetic Rehabilitation”

Francesco Ferrini, Francesca Cattoni, Roberto Sgreccia, Federica Mazzoleni, Carlotta Coppo, F. Bova

PP07 • The presence of enterococcus faecalis in saliva as a risk factor for endodontic infection

Carlo Gaeta, Crystal Marruganti, Emanuele Mignosa, Giulia Malvicini, Edoardo Ferrari, Simone Grandini

PP08 • Temporomandibular joint acoustic signals database.

Justyna Grochala, Marcin Kajor, Dominik Grochala, Jolanta E. Loster

PP09 • Assessment of information about oral appliance therapy for the obstructive sleep apnea on websites

Elvin Günel, Hüseyin Mehmet Kurtulmuş, Lamia Najafova, Hayal Boyacıoğlu

PP10 • A randomized controlled trial on lithium disilicate partial crowns using a novel prosthodontic Functional Index for Teeth (FIT)

Edoardo Ferrari Cagidiaco, Matteo Landi

PP11 • Applications in aesthetic prosthesis of diode laser soft tissue surgery and laser biostimulation

Massetti G., C. Coppo, F. Mazzoleni, F. Monosi, F. Bova, F. Cattoni

PP12 • Different build up procedures of endodontically treated anterior teeth

Hazem Muneef, Edoardo Ferrari Cagidiaco, Denise K.I Pontoriero, Marco Ferrari

PP13 • Mouthguard Usage: Knowledge and Awareness of Sports-related Dental Injury Among National Paralympic Athletes

Nurul Hanim Othman, Aiemeeza Rajali, Nik Rahayyu Nik Zulkifeli, Kamarul Hashimy Hussein

PP14 • Is Deep Margin Elevation a Viable Alternative for Extensive Carious Lesions? A Review

Theodora-Kalliopi Samartzis, Dimokritos Papalexopoulos, Evangelia Zervou, Anna Strigoni, Eleni Ypsilanti, Nikitas Sykaras

PP15 • Evaluation of Clinical Performance of Different Occlusal Splint Materials

Pecenek Duygucan, Ayvalioglu Demet Çağıl, Gokcen-Rohlig Bilge

PP16 • Evaluation of two lithium disilicate system using a novel prosthodontic Functional Index for Teeth (FIT)

Rossit M., Ferrari Cagidiaco E., Ambu L., Ferrari M.

PP17 • Different build up procedures of endodontically treated posterior teeth

Andrea Samman, Edoardo Ferrari Cagidiaco, Denise K.I. Pontoriero, Marco Ferrari

PP18 • Tooth Wear Severity and Temporomandibular Joint Status: A Magnetic Resonance Imaging Study

Ovidiu Ionut Saracutu, Marco Ferrari, Anna Colonna, Luca Guarda-Nardini, Daniel Paesani, Daniele Manfredini

PP19 • fMRI Study on Facial Perception After Complex Aesthetic Rehabilitation: Perception of the Self and the Perception of Others' Face

Roberto Sgreccia, Francesca Cattoni, Francesco Monosi, Riccardo Uccioli, Giorgio Gastaldi, Daniela Perani

PP20 • How Digital Workflow Improves Efficiency and Predictability of Composite-Resin in the Treatment of Erosive Toothwear

Miss Menna Shykhon and Mr David Green

PP21 • Post-menopausal Osteoporotic Women's Life Quality with Dental Implant Restorations with or without Hormone Replacement Therapy

Spyridon Stefos, Stefanos Kourtis, Sophia Kalantaridou, Areti Augoulea, Thomas Vrekoussis

PP22 • Effectiveness of Low Level Laser Irradiation on management of Temporomandibular Joint Disorders: clinical cases

Anna Theocharidou

PP23 • Effectiveness of occlusal splint therapy in the management of temporomandibular disorders pain: a systematic review

Alexandros Tournavitis, Dimitrios Tortopidis, Evangelos Sandris, Maria Kokoti, Theodora Slini, Petros Koidis

PP24 • A Randomized Controlled Clinical Trial on Two Types of Lithium Disilicate Partial Crowns

Vasileios Tsiplakis, Edoardo Ferrari Cagidiaco, Francesco Neri, Hazim Munief Yousef Othman, Marco Ferrari

PP25 • Effect of Post-curing at Nitrogen Gas on Mechanical Properties of Water-stored 3D-printed Hard Occlusal Splint

Junichiro Wada, Kanae Wada, Mona Gibreel, Sufyan Garoushi, Pekka K. Vallittu, Lippo Lassila

PP26 • Evaluation of the Thermographic Examination of Blood and Lymphatic Vessels' Presence in Teeth Qualified for Fixed Prosthesis Performance

Kamila Wiśniewska, Maria Szymonowicz, Piotr Kuroпка, Zbigniew Rybak, Maciej Dobrzyński

PP27 • Fiber Post-Core-Crown Restoration With Short-Fibre Reinforced Flowable Composite

Sadullah Uctasli, Unsun Yagci

PP28 • Deviation between Arbitrary and Kinematic Hinge Axis of the Mandible through Instrumental Functional Analysis

Nikolaos Zokaris, Marcus Greven, Dimos-Dimitrios Mitsikostas, Michail Tzakis, Vasileios Psarras

Thursday, September 22 - Digital prosthodontic research

PP29 • In vitro Comparative Analysis of Marginal Fit in CAD/CAM Full Crowns

Antonela Berar, Gheorghe Zsolt Nicula, Andreea Radulescu, Vlad Bocanet, Smaranda Buduru

PP30 • Study of trueness in CAD/CAM complete dentures

Antonela Buljanović, Mia Čaušević, Krešimir Domazet, Lovre Topić, Nikša Dulčić, Samir Čimić

PP31 • In Vitro Evaluation of Accuracy and Precision of New Medit i700 Intra-Oral Scanner
Matteo Barbini, Carlotta Coppo, Lorenzo Franceschi, Federica Mazzoleni, F. Ferrini

PP32 • BioHPP: A New Alternative Material for Hybrid Implant Prosthesis
Dilara Eđer, Emre Diker, Hakan Terziođlu

PP33 • Dimensional stability of 3D printed fixed prosthetic restorations
Giulia Gallo, Vittorio Cerbino, Guido Bettarini, Omar, Marco Ferrari

PP34 • Differences in Dental Arches Best-fit Superimposition Methods: an In-vitro Study
Grande Francesco, Moscabalma Alessandro, Mussano Federico, Catapano Santo

PP35 • Digital versus analogue impression accuracy for the denture bearing edentulous maxilla-A systematic review
Kalligiannis Antonios, Vourvachaki Maria-Eirini, Pisiotis Argyrios

PP36 • Effects of post-curing light intensity on mechanical and biological properties of 3D printed resin
Min-Jung Kang, Jung-Hwa Lim, Jong-Eun Kim

PP37 • A Comparative Study of the Accuracy of Dental CAD Programs in Designing a Fixed Partial Denture
Yong-Sang Lee, Sung Yong Kim, Kyung Chul Oh, Hong-Seok Moon

PP38 • Different Palatal Morphologies On Trueness And Accuracy Of Intraoral Digital Impressions: An In Vitro Study
Renato Leone, Roberto Sorrentino, Gennaro Ruggiero, Fernando Zarone

PP39 • Hybrid digital complete denture: from SET (Simplified Edentulous Treatment) clinical data to digital denture. Case report
Marco Leone, Alessio Acquadro, Santo Calio, Gassino Gianfranco, Paola Ceruti

PP40 • Immediate implant placement and restoration of a failing lateral upper incisor through a digital workflow
Konstantinos Levantis, Meni Chatzinikolaou, Theodoros Gonidis, Aspa Sarafianou, Phophi Kamposiora, Georgios Papavasileiou

PP41 • Supra-Room Temperature 3D Printing Favorably Modifies the Physical Properties and Accuracy of Resin Material
Jung-Hwa Lim, Jong-Eun Kim

PP42 • “Digital Project Combined With Functional Evaluation In Implant-Prosthetic Rehabilitation In Aesthetic Area”

Federica Mazzoleni, Matteo Barbini, Coppo Carlotta, Roberto Sgreccia, Francesca Cattoni, Francesco Ferrini

PP43 • Minimal Invasive Preparation Strategies for Misaligned Incisors: A Digital Approach

Evangelia-Aglaia Theodorou, Konstantinos Marinis, Theodoros Tasopoulos, Ilias-Christos Gardikiotis, Olga Naka, George Kouveliotis, Panagiotis Zoidis

PP44 • Digital dentures and patient perceptions: a literature review.

Aspasia Pachiou, Anna Strigoni, Panos Lampropoulos, Stefanos Kourtis

PP45 • S.E.M. Evaluation of the marginal accuracy of zirconia, lithium disilicate, and composite single crowns made by cad/cam method: comparative analysis of different materials

Francesco Ferrini, Gaetano Paolone, Paolo Capparè, Nicolò Pagani, Jacopo Silvestri Devarda, Enrico Felice Gherlone

PP46 • Trueness of intraoral scanners in implant-supported rehabilitations: an in vitro analysis

Nicolò Pancini, Paolo Pesce, Francesco Bagnasco, Marco Colombo, Luigi Canullo, Maria Menini

PP47 • Accuracy of Digital Dental Models Obtained by Intraoral and Extraoral Scanning: An In Vitro Comparison

Mihaela Pantea, Robert-Cătălin Ciocoiu, Ana Maria Cristina Tancu, Marina Imre, Alexandru Eugen Petre

PP48 • Effect of Post-curing Conditions on Color Stability of 3D Printed Resin

Jong-ha Park, Sang-yub Lee, Jung-Hwa Lim, Jong-eun Kim

PP49 • Innovative and Digital technologies in aesthetic fixed prosthodontic

Sciacero G., M. Barbini, C. Coppo, F. Mazzoleni, F. Monosi, R.Sgreccia

PP50 • SEM evaluation of the marginal precision of lithium disilicate crowns milled with cad / cam method on single elements: an in vitro study

Francesco Ferrini, Giorgio Gastaldi, Paolo Capparè, Jacopo Silvestri Devarda, Nicolò Pagani, Enrico Felice Gherlone

PP51 • Masking Evaluation of Multi-layered Hybrid Resin Blocks for CAD/CAM

Shuji Kariya, Yutaka Shinozaki

PP52 • Accuracy of Fit of Full-Arch, Implant-Supported Protheses Fabricated Fully Digitally: A Clinical-Simulation in Vitro Study.

Georgia Vasileiadi, Evangelos Ximinis, Katia Sarafidou, Alexandros Tsouknidas, Maria Kokoti, Athina Bakopoulou

PP53 • A Success Rate of Digital Methods in Colour Measurement of Teeth

Lenka Vavrickova, Martin Kapitan, Hana Hubalkova, Jindrich Charvat Jn., Marie Bartonova

PP54 • Comparison of Two Intraoral Scanners for the Realization of Lithium Disilicate Crowns

Giulia Verniani, Marco Ferrari

Friday, September 23 - Prosthodontic research

PP55 • The I-SET (implant-simplified edentulous treatment):

Simplification in implant-supported prosthesis.

Alessio Acquadro, Francesco Grande, Santo Catapano, Paola Ceruti

PP56 • Outcomes of dental porcelain and ceramic laminate veneers: A rapid umbrella review

Afrashtehfaz KI, Özcan M.

PP57 • Selection of Temporary Cement, Desensitizing Agent and Cleaning Protocol Before Cementation of Ceramic Restorations, Pilot Survey

Ahmad Alghamdi, Abdulmajeed Alotaibi, Christel Larsson, Evaggelia Papia, Eva-Karin Korduner

PP58 • Does fluoride, eugenol and cleaning protocols affect the final bond

of Lithium-di-silicate to Human dentin?

Abdulmajeed Alotaibi, Ahmad Alghamdi, Christel Larsson, Evaggelia Papia.

PP59 • The Effect of Different Pretreatments and Cleaning Methods Prior Adhesive Cementation of Lithium disilicate Restoration.

Abdulmajeed Alotaibi, Ahmad Alghamdi, Christel Larsson, Evaggelia Papia

PP60 • Evaluation of Microcracks Formed by Grinding in Lithium Silicate Glass-ceramic block for CAD/CAM.

Toshihiko Azuma, Yusuke Murata, Yusuke Hokii, Shigenori Akiyama, Yutaka Shinozaki

PP61 • Wireless Technologies Compared. Precision and Accuracy on Screw-Retained Full-Arch Implant Rehabilitation

Matteo Barbini, Carlotta Coppo, Federica Mazzoleni, F. Ferrini

PP62 • Mandibular single implant retained overdenture: functional, radiographic and prosthetic results at ten years follow-up.

Elisabetta Bellia, Gianfranco Gassino, Marco Murgia, Francesco Bassi, Paola Ceruti

PP63 • Evaluation of Shear Bond Strength of two Highly Translucent Monolithic Zirconia to Self-Adhesive Cement after Different Surface Pretreatment

Sirageddin Al-hmadi, Nuray Capa

PP64 • Are Mini-Implants Suitable for Support of Crowns or Small Bridges in the Mandibular Incisor Region? A 5-year longitudinal study

Anka Coric, Ines Kovacic, Nikola Petricevic, Irina Filipovic Zore, Sanja Persic-Kirsic, Asja Celebic

PP65 • Framework Materials for Full-Arch-Implant-Supported Rehabilitations: an in vitro study

Luisa De Giorgis, Francesca Delucchi, Paolo Pesce, Fabrizio Barberis, Alberto Lagazzo, Maria Menini

PP66 • Factors Affecting the Clinical Efficacy of Metal-Free Double Crown Systems

Evangelos Deligiannis-Skondras, Eftychia Deligianni-Skondra, Theodoros Tasopoulos, Christos Vasilaras, Olga Naka

PP67 • Effect of the abutment materials on tissue health and stability – a network meta-analysis

Francesca Delucchi, Massimo Del Fabbro, Maria Menini, Emanuele De Giovanni, Luigi Canullo, Paolo Pesce

PP68 • A 16-Year Prospective Clinical Study on Maxillary Lateral Incisor Agenesis Treated With Narrow Diameter Implants

Maria Irene Di Mauro, Roberto Sorrentino, Fernando Zarone

PP69 • Outcomes of zygomatic implants combined with anterior regular implants: retrospective analysis with a mean follow-up of 36 months

Gamalero M, Tealdo T, Bagnasco F, Pesce P, Pera F, Menini M

PP70 • Zygomatic implants combined with anterior regular implants:

retrospective analysis with 36-month follow-up

Marco Gamalero, Tiziano Tealdo T, Francesco Bagnasco F, Paolo Pesce, Francesco Pera, Maria Menini

PP71 • High Flowability into Wet Sulcus of Paste-type Alginate Impression Material

Ayumu Hirano, Atsushi Tachino, Yutaka Shinozaki

PP72 • Evaluation of wear resistance in machinable Lithium Disilicate Glass-Ceramics
Yusuke Hokii, Toshihiko Azuma, Shigenori Akiyama, Yutaka Shinozaki

PP73 • Resin Bonding to CAD/CAM and Pressed Lithium-Disilicate after Surface Decontamination

Uros Josic, Federico Del Bianco, Tatjana Maravic, Claudia Mazzitelli, Lorenzo Breschi, Annalisa Mazzoni

PP74 • Effectiveness of Antimicrobial Agents Incorporated into Soft Denture Liners: A Systematic Review

Eirini Katmerou, Frixos Frixou, Theodoros Tasopoulos, Olga Naka

PP75 • A Comparative Study of Accuracy of Implant Surgical Guide Fabricated from Two Different 3D Printers

Sung Yong Kim, Yong Sang Lee

PP76 • GBR Using Pre-contoured Titanium Mesh Simultaneously with Implant Placement to Obtain Favorable Crown-Implant Ratio

Jeong-Woong Kim, Bo-Ah Lee, Jin-Ho Chung, Subin Hong, Young-Taek Kim

PP77 • In vivo comparison of bone response between titanium and zirconia implant surfaces

Jeong Min Kwak, Jin-Cheol Kim, In-Sung Yeo

PP78 • Factors influencing the frequency of denture adjustments after delivery of complete denture: a retrospective study

Seungwon Lee, Jinjoo Yu, Junho Yoon

PP79 • Reliability of RFA and DCA for implant stability measurement according to devices' accessibility to implants

Han-na Lee, Ji-Seok Shim, Jae-Jun Ryu, Jeong-Yol Lee

PP80 • Factors influencing the frequency of denture adjustments after delivery of complete denture: a retrospective study

Seungwon Lee, Jinjoo Yu, Joonho Yoon

PP81 • Reliability of Digital Shade Selection: An In Vivo Study

Meltem Mert Eren, Demet Çağıl Ayvalıoğlu

PP82 • Therapy of the lower jaw using overdenture retained with precision ball and bar attachments.

Poštić SD, Ristić Lj., Dorđević I., Šojić P.

PP83 • Influence of thermocycling and thickness on fracture resistance of resin cements between two titanium surfaces: An in vitro study

Pozzan Mario Cesare, Grande Francesco, Rostyslav Vlasyi, Scotti Nicola, Carossa Massimo, Catapano Santo

PP84 • The Shear Bond Strength Between Milled Denture Base Materials and Artificial Teeth: a Systematic Review

Vladimir Prpić, Amir Čatić, Sonja Kraljević Šimunković, Samir Čimić

PP85 • Comparison of Wear Resistance of Cement Line of Resin Cements

Keita Sato, Kyouzuke Hirano, Yutaka Shinozaki

PP86 • Evaluation of tensile bond strength of self-adhesive resin cement and glass-ionomer cement to zirconia

Koji Tanaka, Enzo Shida, Daiki Machida, Yutaka Shinozaki

PP87 • Fully Guided Immediate Implant Placement and Immediate Loading for Full-arch Rehabilitation: A Clinical Report

Evangelia Zervou, Evangelia Zampa, Aspasia Pachiou, Panagiotis Lampropoulos, Spyridon Vassilopoulos, Stefanos Kourtis

Friday, September 23 - Case presentation

PP88 • The Indirect Onlay Restoration of an Extensively Damaged Lower Molar: a Collaborative Case Report

Doruk Altıok, Yusuf Kamani, Bulem Yüzügüllü Tütüncüler

PP89 • Restorative Treatment of a Patient with Amelogenesis Imperfecta: a Case Report

Aspasia Chalazoniti, Stefanos Kourtis

PP90 • Dental erosion in gastroesophageal reflux disease- an in vitro study and case report

Andrea Maria Chisnoiu, Mara Simon, Diana Tabarcea, Andreea Stanciu, Andreea Kui, Simona Iacob, Radu Chisnoiu, Smaranda Buduru

PP91 • “2D And 3D Project Rehabilitation In Aesthetic Area: A Case Report”

Flavio Giubilato, Federica Mazzoleni, Matteo Barbini, Roberto Sgreccia, Francesco Ferrini, Francesca Cattoni

PP92 • “Minimally Invasive Techniques For The Resolution Of A Bilateral Posterior Edentoullism: Case Report”

Alessandro Gonnella, Francesca Cattoni, Roberto Sgreccia, Francesco Ferrini, Michele Manacorda, Raffaele Vinci

PP93 • Full-mouth Rehabilitation of a Bulimic Patient with All-ceramic Table-tops and Canine Chips

Katia Sarafidou, Rafailia Karpouzi, Eleftheria Zachari, Sotirios Gotsis, Maria Kokoti, Athina Bakopoulou

PP94 • Rehabilitation With Mini Invasive Techniques Of The Lateral Mandibular And Edentulous Sector: A Case Report

F. Monosi, R. Sgreccia, F. Mazzoleni, A. Merlone, M. Manacorda, R. Vinci

PP95 • Minimally Invasive Esthetic Rehabilitation of Congenitally Missing Lateral Incisors: A Clinical Report

Aspasia Pachiou, Panagiotis Roulias, Evangelia Zervou, Charitomeni Chatzinikolaou, Iliia Roussou, Stefanos Kourtis

PP96 • Maxillary All-on four VS six implants supported fixed prostheses: Case reports

Alexandros Tournavitis, Evangelos Ximinis, Savina Germeni, Panagiotis Pandoleon, Dimitrios Tortopidis

PP97 • “Correct Programming And Choice Of The Type Of Preparation In Prosthesis: Case Report”

Luisa Paoleschi, Federica Mazzoleni, Carlotta Coppo, Matteo Barbini, Roberto Sgreccia, Stefano Speroni

PP98 • Combining Teeth and Implants as Abutments for Partial Removable Dentures: Report of two cases

Dimokritos Papalexopoulos, Aikaterini Kaitatzidou, Kalliopi Konstantopoulou, Aspasia Sarafianou

PP99 • Immediate Loading of Implant-Supported Full-Mouth Hybrid Prostheses Using CoDiagnostiX®: An Alternative Solution for Severe Cases

Can Hakan Sarikaya, Hakan Terzioglu

PP100 • Aesthetic Rehabilitation of a Patient with Previously Unsuccessfully Treated Upper Incisors Using Lithium Disilicate Crowns

Duška Stopar, Petra Šterbenk

PP101 • Rehabilitation of maxillary edentulism with monolithic zirconia implant-supported prostheses reinforced by metal milled-bar framework.

Anna Chara Tasakou, Stamatina Grigoriou, Faye Alexandridi, Phophi Kamposiora

PP102 • Integrating digital and traditional prosthodontic concepts for the rehabilitation of a worn-down dentition.

Vasilaki Dimitra, Michalakis Konstantinos

PP103 • Prosthodontic Rehabilitation of a Young Patient with Langerhans Cell Histiocytosis: A Clinical Case Report

Eleni Ypsilanti, Aspasia Pachiou, Nikolaos Apostolidis, Dimokritos Papalexopoulos, Nikolaos G. Nikitakis, Ioli Artopoulou

PP104 • Implant-supported Full-mouth Rehabilitation in Patient with Squamous Cell Carcinoma after Reconstructive Surgery

Katia Sarafidou, Eleftheria Zachari, Rafailia Karpouzi, Sotirios Gotsis, Athina Bakopoulou, Maria Kokoti

PP105 • Selection of Precision Attachment for Attachment-retained Partial Denture Prostheses: A Case Series

Nurul Jannah Zulkefle, Mohd Zulkifli Kassim, Nurul Hanim Othman, Noor Aaina Zainon, Aiemeeza Rajali, Tengku Fazrina Tengku Mohd Ariff

GENERAL INFORMATION

45TH EPA CONGRESS

EUROPROSTHO

European Prosthodontics looks forward

CONGRESS VENUE

University of Siena
 “Complesso Universitario Mattioli”
 Via Pier Andrea Mattioli, 10
 53100, Siena – Italy

SECRETARIAT AND REGISTRATION DESK

- Thursday September 22, hrs 07.30-18.00
- Friday September 23, hrs 07.30-18.00
- Saturday September 24, hrs 07.30-14.30

ON-SITE REGISTRATION

REGISTRATION VAT 22% is not included	On-site Registration from 22 nd September 2022 onwards
EPA Members	400,00 €
Non-Members	500,00 €
Invited Scientific Societies Mem <i>SIPRO, EDAD, SIdP, ANDI, AIOP, AIC</i>	400,00 €
Students	290,00 €
Dental Technicians	300,00 €
Auxiliary Personnel	330,00 €
Accompanying Persons	50,00 €

Congress Registration fee includes:

- Access to all congress sessions and exhibition area
- Congress materials and a name badge
- Scientific Programme
- Certificate of Attendance
- Welcome Reception
- Refreshment breaks during the congress

ADMISSION

Participants are kindly requested to wear their badge during all congress activities. The badge will admit to the scientific sessions, coffee breaks and lunches.

WELCOME RECEPTION

The Welcome Reception will be held on September 22nd from 18.00

ANNUAL BUSINESS MEETING

It will be held on Saturday, September 24th at 14:30 in Room B

SOCIAL DINNER

The Social Dinner (upon payment) will be held on September 23, hrs 19.30, at the Certosa di Pontignano, a timeless location a few kilometers away from Siena. Address: località Pontignano, 5 – 53019- Castelnuovo Berardenga, Siena – Tuscany.

COST (VAT 22% NOT INCLUDED)

Under 35 – € 50,00

Over 35 – € 62,00

The cost includes transfer from/to the dinner venue. The buses will leave from NH Siena Hotel (Via La Lizza, 1, 53100 Siena) at 18:45.

If you paid for your seat, do not forget to pick up the invitation card at the Registration Desk.

The dinner has a limited number of seats, if you are interested in purchasing a ticket, please go to the organizing secretariat desk to check for availability.

CUSTOMER SATISFACTION SURVEY & CERTIFICATE OF ATTENDANCE

At the end of the event, you will receive an online survey to score the main congress services. This will help us doing better in the future. Your attendance certificate will be ready for download at the end of the survey.

LANGUAGE

The official language is English. No simultaneous translation will be provided.

TAXI

Contact +39 0577 49222

SAFETY MEASURES

The Organizing Secretariat is strongly committed to deliver the safest in presence event and is constantly monitoring the global health situation.

Conference spaces are suitable to host safely all registered attendees and do comply with current public health guidance.

The Organizing Secretariat Staff will constantly check the flows in the congress area to avoid any crowding.

For everyone's safety, we kindly invite all delegates to wear face masks in all conference spaces and sanitize your hands frequently.

Delegates are kindly requested to set their mobile phones on silent mode in the Auditorium where scientific sessions are being held.



45TH EPA CONGRESS
EUROPROSTHO
 European Prosthodontics looks forward

September 22nd - 24th, 2022
 University of Siena, Italy

Booth

6	3M
11	BIOSAFIN
5	DENTSPLY SIRONA
1	GC
4	INTENSIV SA SWISS DENTAL PRODUCTS
14	IVOCLAR VIVADENT
8	KURARAY NORITAKE
7	LYRA DENTAL
12	RHEIN83
9	SWEDEN & MARTINA
10	OXY IMPLANT - Biomec Srl

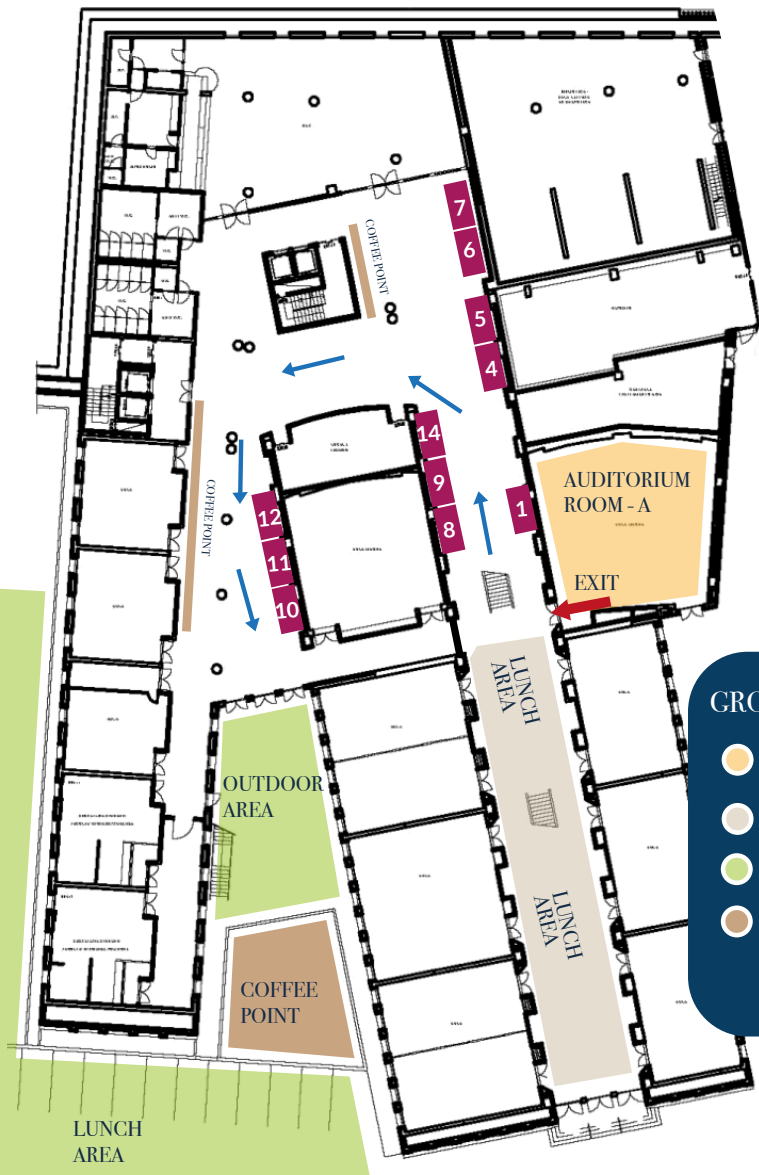

GROUND FLOOR

- AUDITORIUM ROOM - A
- LUNCH AREA
- OUTDOOR AREA
- COFFEE POINT

exhibition area

4 mt (length) x 2 mt (depth)

45TH EPA CONGRESS

EUROPROSTHO

European Prosthodontics looks forward

September 22nd – 24th, 2022
University of Siena, Italy



EPA European
Prosthodontic
Association



SIPRO
Società Italiana di
Protesi Dentaria e
Riabilitazione Orale

PLATINUM SPONSORS



GOLD SPONSORS



SILVER SPONSORS



MEDIA SPONSORS





Organizing Secretariat



First Class S.r.l. Meetings and Conferences
Via L. Mascheroni, 17 - 20145 Milano
Ph. +39 02 30066329

Viale Italia, 173 57127 - Livorno
Ph. +39 0586 849809
epa2022@fclassevents.com



EPA SIENA 2022

45TH EPA CONGRESS
EUROPROSTHO
European Prosthodontics looks forward

September 22nd - 24th, 2022
University of Siena, Italy

EPA European
Prosthodontic
Association



Organizing Secretariat



First Class S.r.l. Meetings and Conferences
Via L. Mascheroni, 17 - 20145 Milano
Ph. +39 02 30066329

Viale Italia, 173 57127 - Livorno
Ph. +39 0586 849811
epa2022@fclassevents.com